

# STANDARD Q RSV Ag



## Quick-test with reliable performance

RSV (Respiratory syncytial virus) is a syncytial virus that causes highly contagious and acute viral infection of the respiratory tract. The virus is transmitted from person to person via close contact, droplets, or fomites. The STANDARD Q RSV Ag Test is an *in vitro* diagnostic use to detect RSV infection in human nasopharyngeal swab/nasopharyngeal aspirate sample, indicating diagnosis of respiratory syncytial virus. This can be used with the appropriate analyzers manufactured by SD Biosensor, Inc. This is intended for professional use, only for an initial screening test.

## Performance Characteristics

Detect	Sensitivity	Specificity
RSV Ag	87.5% (28/32)	98.09% (103/105)
Reference Method : PCR		

## General Information

- Detection of Respiratory Syncytial Virus (RSV) antigens
- Store at 1-40 °C / 34-104 °F
- Specimen type : Nasopharyngeal swab / Nasopharyngeal wash/aspirate
- Testing time : 15mins (Do not read after 30mins)
- Shelf life : 24M

## Material

Test device	Extraction buffer	Filter cap	Fixed volume dropper (300µl)	Control swab (Pos/Neg)	Sterile swab	Instruction for use

## Test procedure | Nasopharyngeal swab

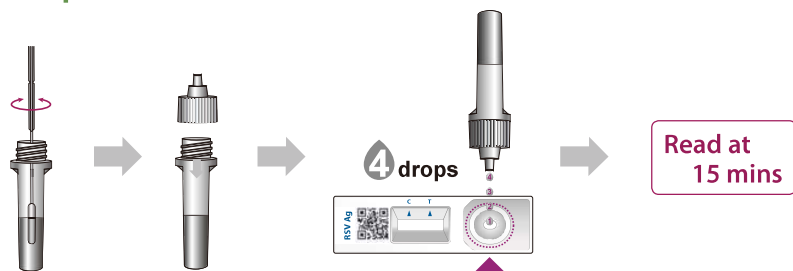

## Interpretation

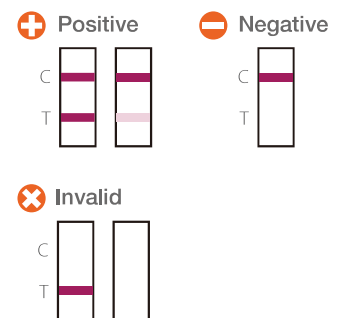

## Ordering Information

Cat. No.	Description	Specimen	Type	Pack size
09RSV10B	RSV Ag	Nasopharyngeal swab / Nasopharyngeal wash/aspirate	Device	20T/Kit